

ASSEMBLY INSTRUCTION

PLEASE READ BEFORE ASSEMBLING!

Tip #1: Make sure you've taken all the pieces and hardware out of its packaging before discarding the box.

Tip #2: Using page 2 and/or page 3 of instruction manual make sure all pieces and hardware are accounted for.

Tip #3: Read manual before assembling, it helps!

ITEM#: 10367-x2

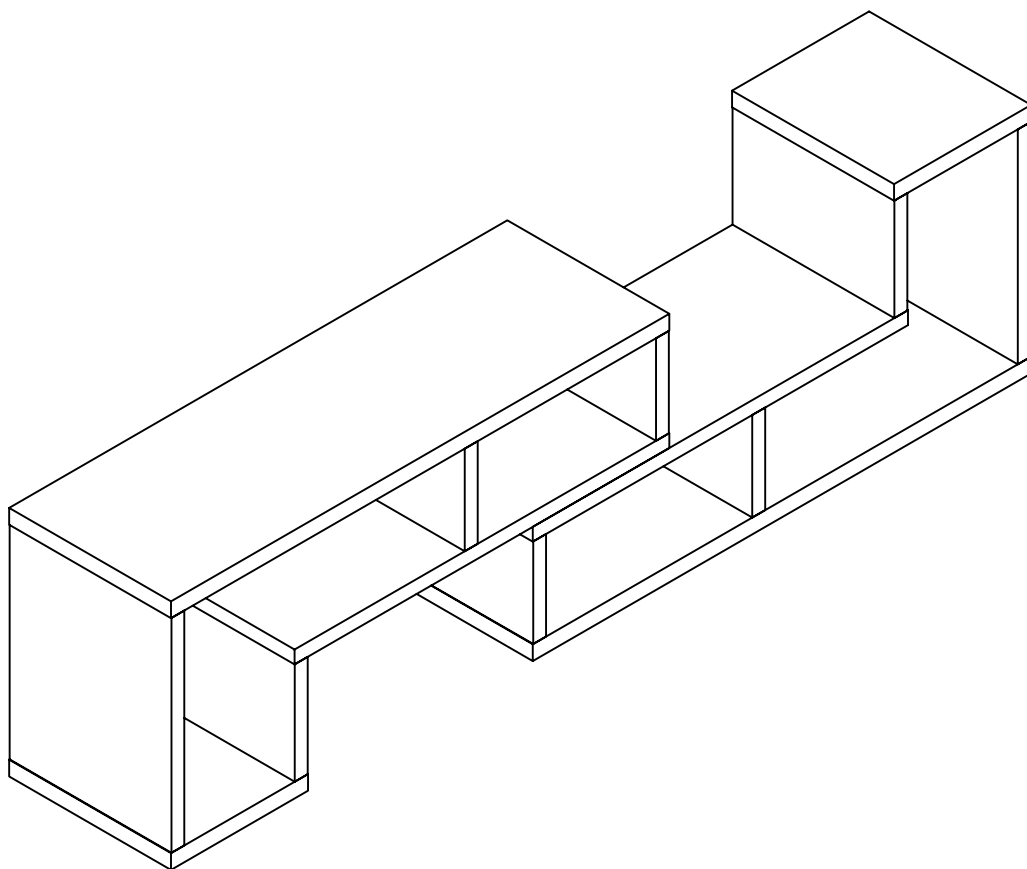

PARTS IDENTIFICATION

ITEM#:10367-x2

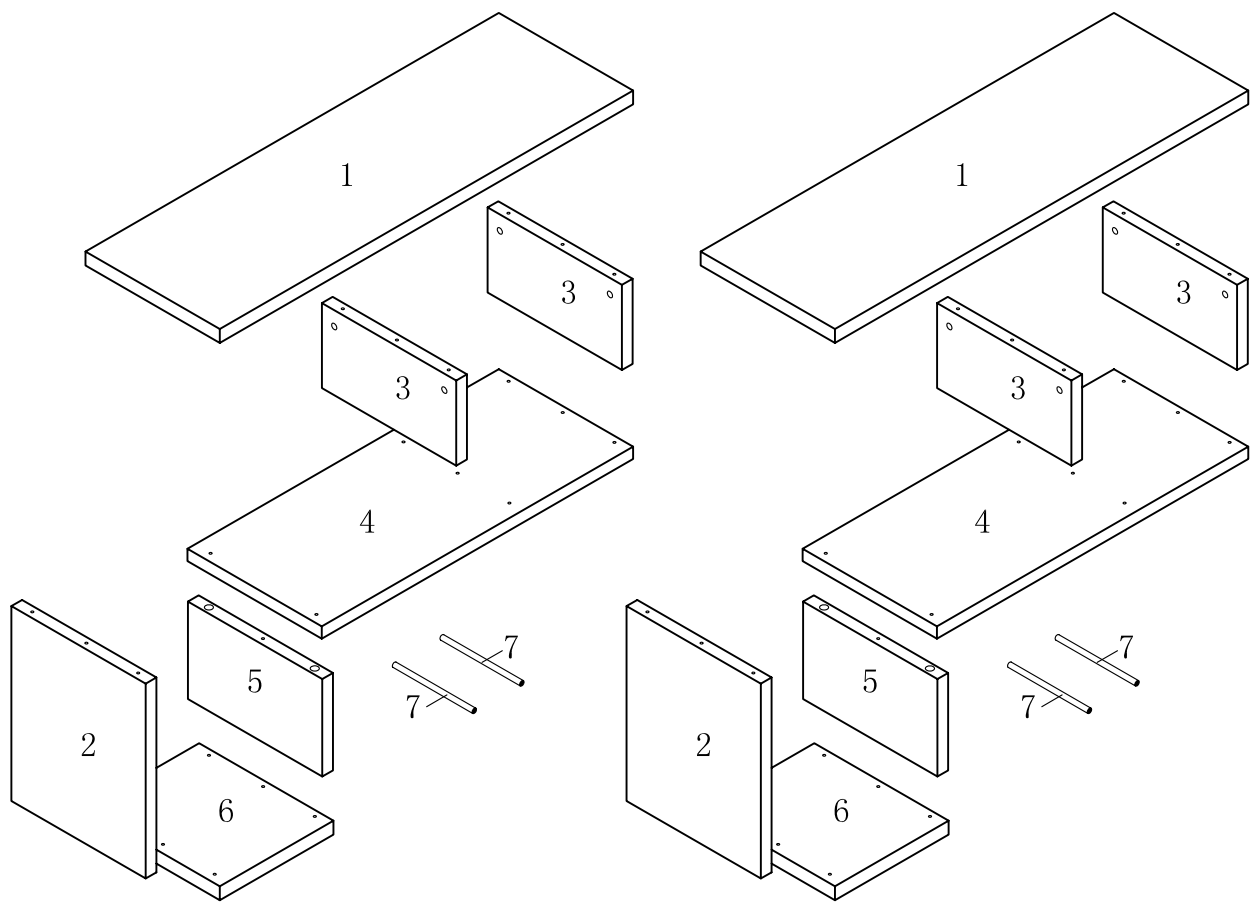

(1)	2pc	(4)	2pc	(7)	4pcs
(2)	2pc	(5)	2pc		
(3)	4pcs	(6)	2pc		

HARDWARE IDENTIFICATION

ITEM#: 10367-x2

A

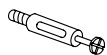

L29

12pcs

B



ϕ 15

12pcs

C



ϕ 8x25

16pcs

D

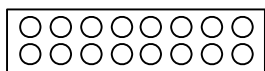

ϕ 18

32pcs

E



ϕ 7x58

12pcs

F



M6x30

8pcs

G



Glue: For securing please apply to wood dowel first before inserting into panel

1pc

STEP1

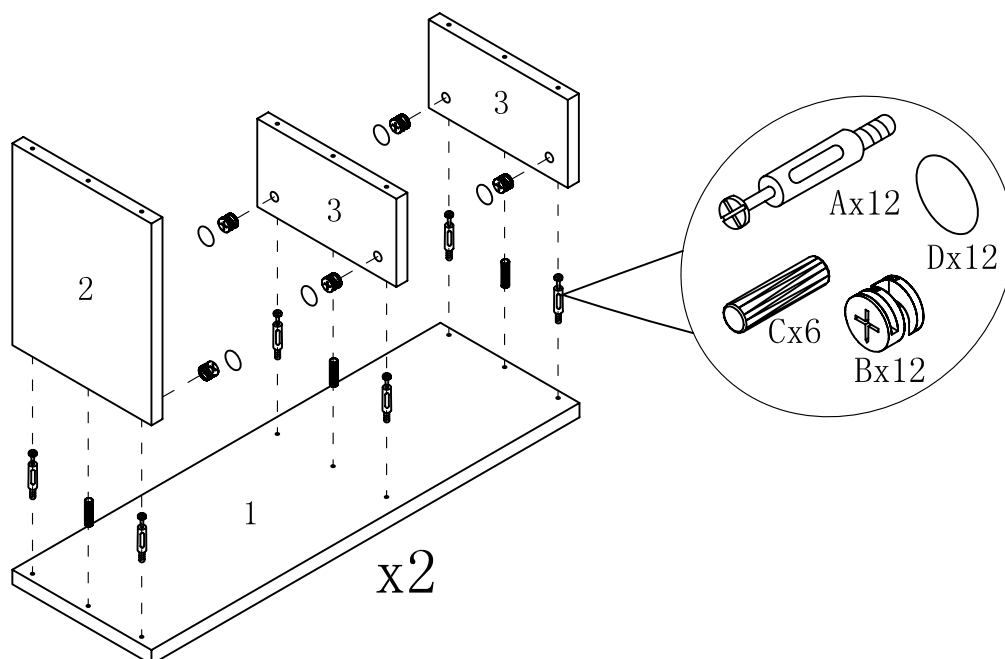

ASSEMBLY INSTRUCTION

ITEM#: 10367-x2

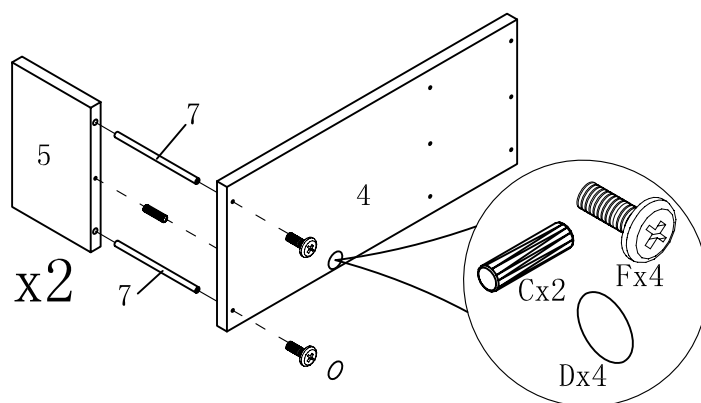

STEP2

STEP3

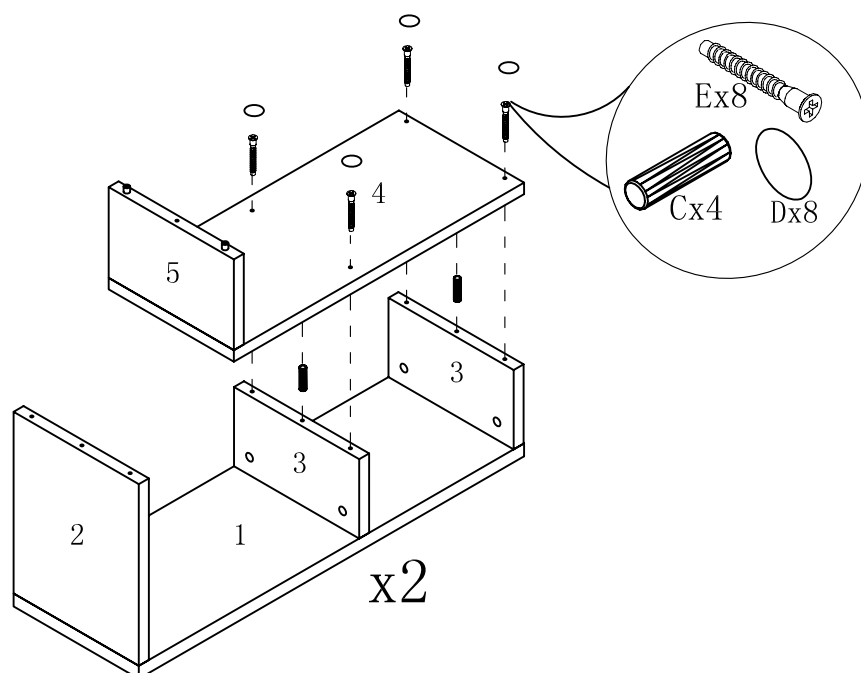

ASSEMBLY INSTRUCTION

ITEM#: 10367-x2

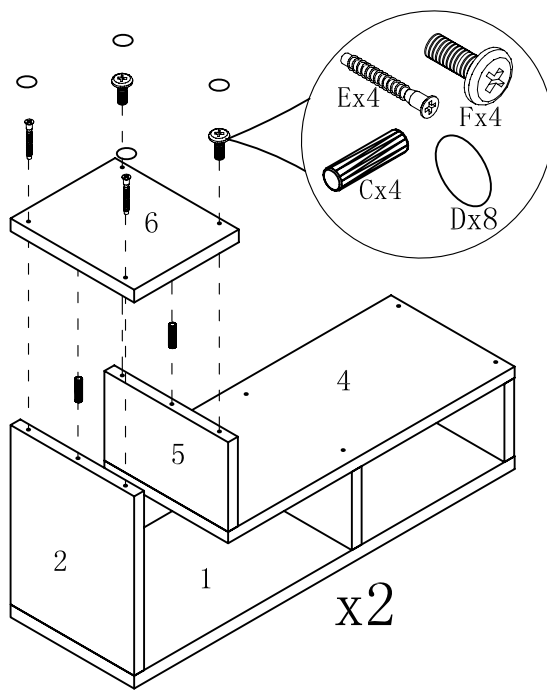

STEP4

STEP5

